

LoRUN G300

Datasheet V1.1

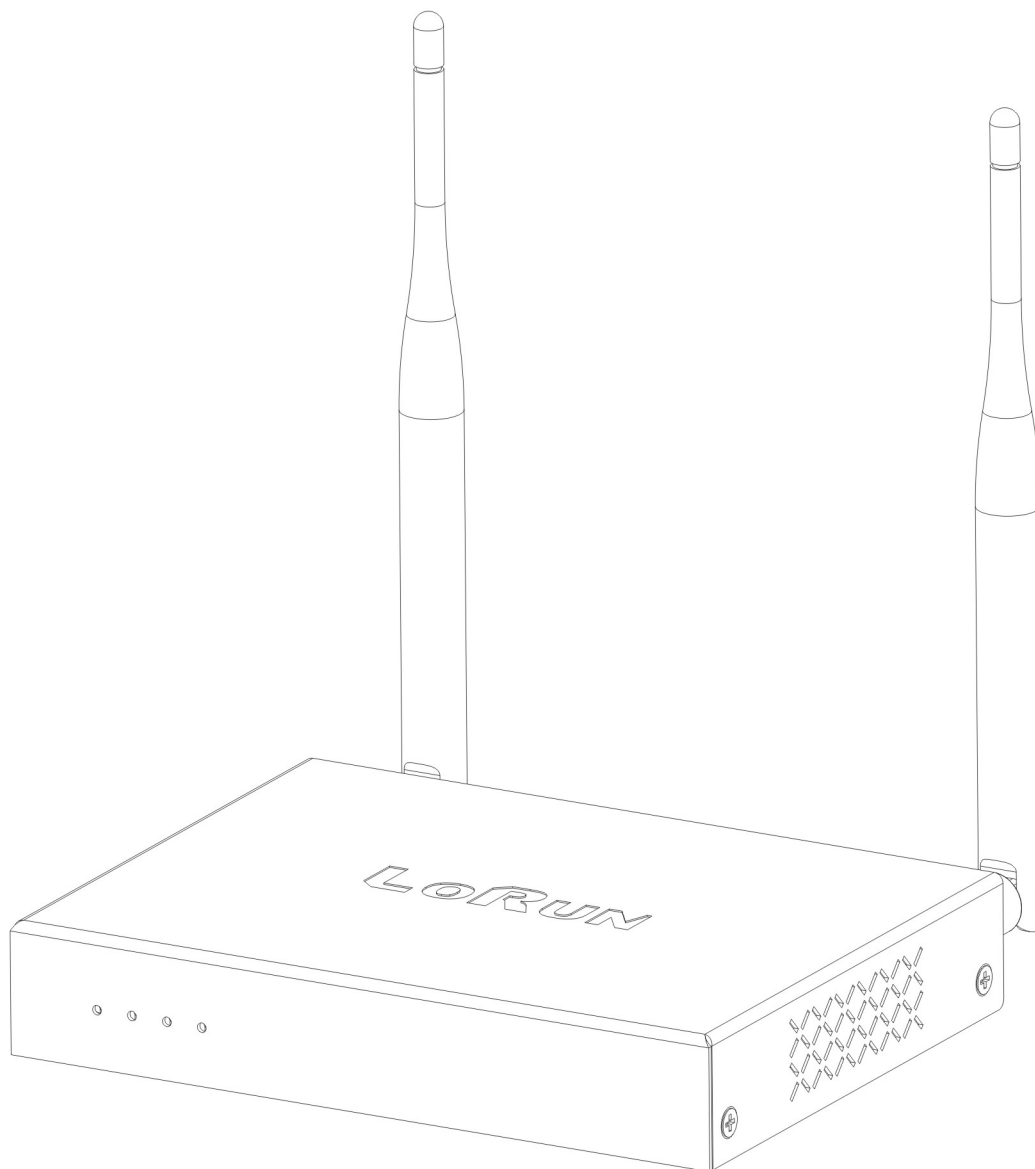

EasyLinkin

Product overview

Brief introduction

LoRun G300 gateway is a low power consumption, low-cost, compact and portable indoor small gateway based on the LoRaWAN protocol, which is also easy to install. Applicable to: the flexible networking of terminal equipment with features of high communication requirements, strong anti-interference ability, high sensitivity, low power consumption, multiple and dispersed access node and so on. It provides users with low cost, high usage, stable and reliable solutions of indoor intelligent Internet of Things.



FIG.1. LoRun G300 indoor small gateway

Product Features

- Compact and portable, and easy to install
- Realize low cost network deployment
- The maximum sensitivity is -140dBm.
- Network stability guarantee:
 - (1) Node roaming. The legal node can move freely within the gateway coverage.
 - (2) When the gateway is abnormal in the multi-gateway network, the node can be accessed through the adjacent gateway.
- Support the power down alarm function
- Remote wireless upgrade and maintenance

Table1. Product specification parameters

Specification	Parameters
Operating frequency	433MHz / 470MHz / 510MHz / 868MHz / 915MHz / 923MHz;
Communication protocol	LoRaWAN
Modulation mode	LoRa/FSK
Channel bandwidth	125KHz,250KHz configurable
Number of channels	Support 8 uplink channels, 1 down channel
Receive sensitivity	-140dBm @SF12/BW 125KHz
Transmitted power	24dBm (250mW) (Typical) @433MHz / 470MHz / 510MHz 23dBm (200mW) (Typical) @868MHz / 915MHz / 923MHz
Transmission rate	
Covering radius	5Km in city, 15Km in the open
Power supply	DC-In 12 V (11.0V~14.0V)
Reset management	One key to restore factory settings
Operating temperature range	0-60℃
Operating humidity range	0-90% RH
Dimensions	160*120*28mm
Structural materials and technology	Aluminum, surface oxidation treatment
Installation	Desktop type, wall-attaching type
Remote management	Can check the status daily log of the device through back-stage management and remote connection
	Support remote upgrade and convenient system maintenance

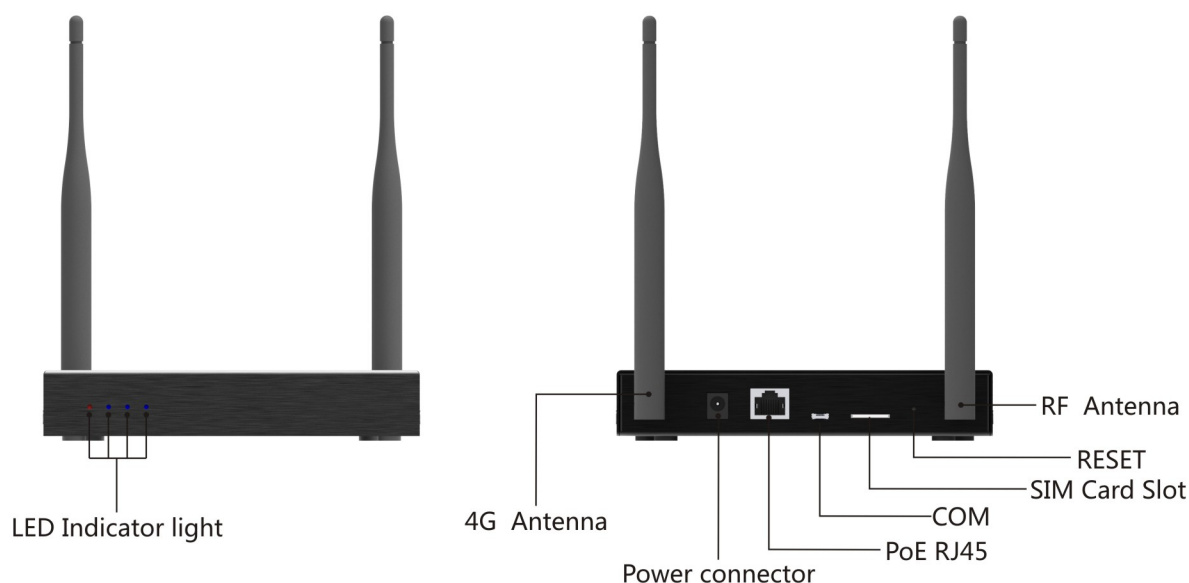
**FIG.2. External view of LoRun G300 product**

Product installation instructions

The LoRun G300 gateway standard design provides two conventional and simple installation methods:

- 1.Desktop type: Place the gateway and power on the horizontal plane, and adjust the antenna direction flexibly, which is suitable for temporary demonstration and debugging.
- 2.Wall-attaching type: Hang the gateway on the wall and fix the installation through the expansion tube and the screw with flexible adjustment.

Installation steps of the wall-attaching type:

Step one

Mounting screw

- ① First of all, open the product package, then use the circular dotted line logo shown in the figure below to mark the installation location of the product on the wall, so as to locate the screw; or directly use a ruler to measure the distance of 103.0mm on the suitable position of the wall, and mark it, so as to install the screws.

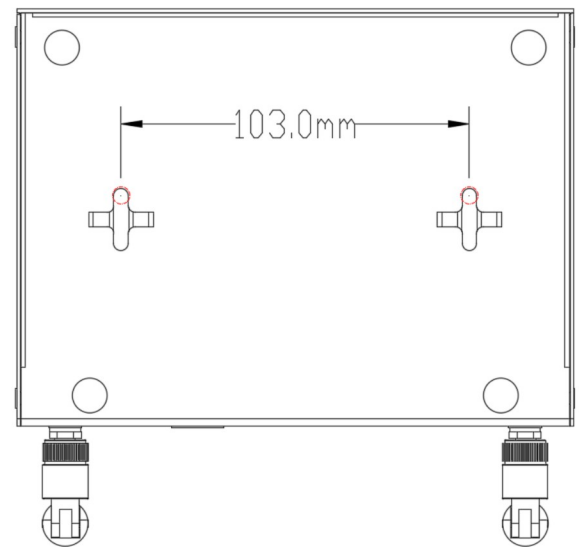

- ② Secondly, respectively use electric drill with the appropriate drill bit to drill the hole on the positioning mark position of the wall, and the nail the expansion tube and screw in turn with the hammer. It is recommended that the outer surface of the screw cap should be 7-10mm away from the wall, and the allowable limit of the cap should be 5-7mm.

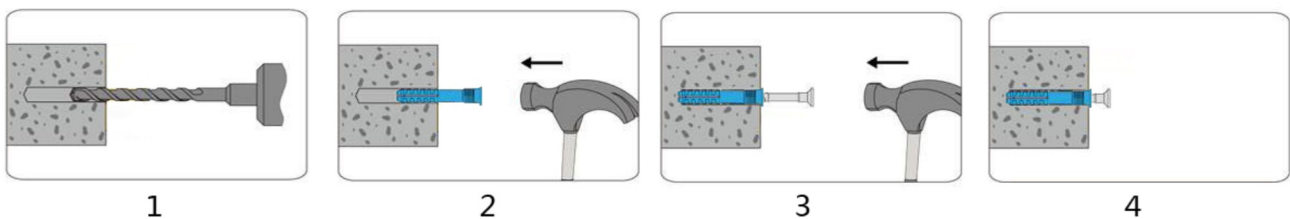

Step two

Antenna installation

①Turn the antenna into the corresponding SMA port on the product according to the marked specification on the label, adjust the Angle of the antenna and lock the nut.

Step three

Product installation







①Connect the product to power supply, network cable or insert 4G cards, then align the hanging hole on the back of the product with the screw after its function operates normally through testing and indicator lamp status is OK through observing, and confirm that the product is firm after hanging into the wall.

②Tidy up and fix the power cord and cable, and mark each wire.

Precautions

- ※The installation position of gateway needs an access path of the I-Cable broadband
- ※The product installation process must be handled gently, and there can be no violent collisions and falls
- ※The product should be installed on the flat wall with small dust and dry ventilation, and do not choose the location that has rain, seepage and humidity

Table 8. Packing list

Serial number	Picture	Name	Quantity (PCS)	Remarks
1		Mainframe	1	
2		Power Adapter	1	
3		RF antenna	1	
4		4G antenna	1	Optional
5		Instructions	1	
6		Certificate and warranty card	1	

Technical Support

In the course of use, if there is any doubt that this document cannot help you solve, please contact the technical staff of LoRun gateway.

This manual is subject to updating without prior notice

© 2017 Easylinkin All Rights Reserved